

FIXTURE TYPE: \_\_\_\_\_  
 PROJECT NAME: \_\_\_\_\_

**BRONZELITE TBC303-12 (300V/300 WATT) INGROUND TRANSFORMER SPEC SHEET**

model TBC303-12



Designed specifically for landscape lighting professionals, TBC in-ground transformers are solidly built with features like magnetic circuit breakers and composite housings. Rugged enough for the harshest environments. With safety and longevity as primary concerns, all Bronzelite transformers are manufactured to meet the stringent UL requirements for landscape lighting applications (UL 1838).

The triple tap output design allows you to lay simultaneous runs of cable at your preference of 11, 12, or 13 volts, a performance feature which permits complete flexibility in your landscape lighting set-up.

Dependability and flexibility merge with outstanding warranty protection making Bronzelite's transformers the professional solution for today's landscape lighting specialists.

**SPECIFICATIONS**

**HOUSING:** Inground housing and cover are compression-molded, fiberglass-reinforced polyester composite material with high-temperature rating. Cover is secured with eight stainless steel screws and sealed with an interior silicone O-ring. Two 3/4" threaded inlets on bottom for conduit entry.

**INSTALLATION:** Housing should be mounted in ground with three inches of gravel or sand surrounding the housing and ground level should be sloped up toward cover. Conduit entry point must be potted inside to prevent leakage.

**ELECTRICAL:** U.L. & cU.L. listed for wet location (Outdoor) inground.

- Separate wiring compartment with two 3/4" 120V inlets.
- The transformer is thermally protected and is shielded between the 120V input and the 12V output for safety, encapsulated for moisture resistance.

- 11, 12 and 13 volt output taps for design flexibility and longer cable run capability.
- Waterproof connectors for low voltage cable outlets (one connector with TBC303-12).
- Potting compound (MA1) for line voltage wiring compartment.
- Line voltage amperage draw: 300VA = 2.7 amps.
- Magnetic circuit breaker with reset switch.

**OPTIONAL:** 220, 240 or 277 volt, 50/60Hz input. Consult factory for details.

**WARRANTY:** Ten year limited warranty.

**CERTIFICATION:** UL Listed to U.S. and Canadian safety standards for wet locations.

**DRAWINGS/TEMPLATES**

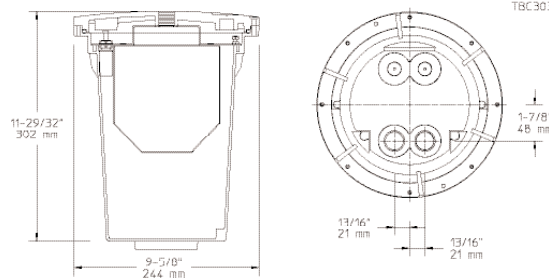

**PROJECT NOTES**

---

---

---

---

---

---

---

---

---

---

---

---

**APPROVAL**

Note: Bronzelite reserves the right to modify the above details to reflect changes in the cost of materials &/or production &/or design without prior notice.  
 BRONZELITE - GENLYTE GROUP LLC • 100 Craftway • Littlestown, PA 17340 • Ph. (800) 273-1569 • Fax (717) 359-9545 • www.bronzelite.com